

PROPERTY LINE

FOR CONTINUATION OF
OFFSITE STORM SEWER
SEE SHEET 11

EXISTING
18" RCP COLL. ERT

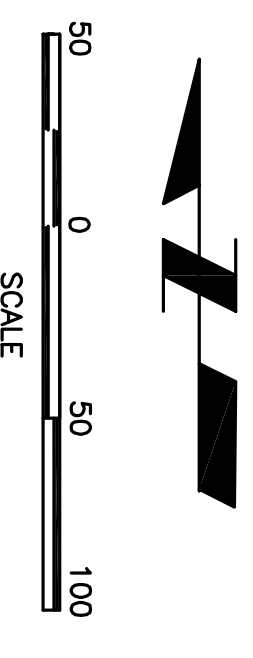
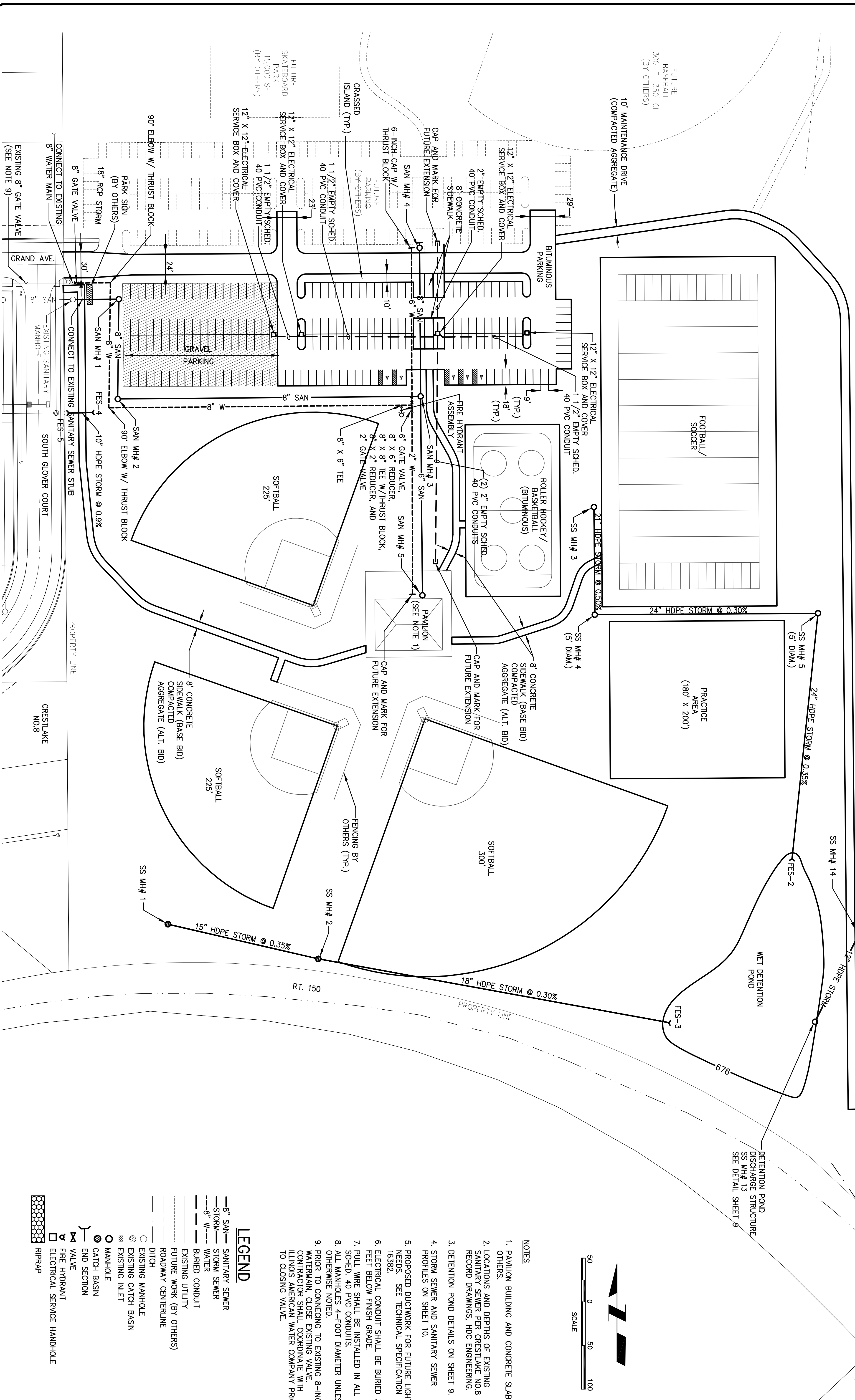

NOTES

1. PAVILION BUILDING AND CONCRETE SLAB BY OTHERS.
2. LOCATIONS AND DEPTHS OF EXISTING SANITARY SEWER PER CRESTLAKE NO. 8 RECORD DRAWINGS, HDC ENGINEERING.
3. DETENTION POND DETAILS ON SHEET 9.
4. STORM SEWER AND SANITARY SEWER PROFILES ON SHEET 10.
5. PROPOSED DUCTWORK FOR FUTURE LIGHTING NEEDS. SEE TECHNICAL SPECIFICATION 16392.
6. ELECTRICAL CONDUIT SHALL BE BURIED 3 FEET BELOW FINISH GRADE.
7. PULL WIRE SHALL BE INSTALLED IN ALL SCHED. 40 PVC CONDUITS.
8. ALL MANHOLES 4-FOOT DIAMETER UNLESS OTHERWISE NOTED.
9. PRIOR TO CONNECTING TO EXISTING 8-INCH WATERMAIN, CLOSE EXISTING VALVE. CONTRACTOR SHALL COORDINATE WITH ILLINOIS AMERICAN WATER COMPANY PRIOR TO CLOSING VALVE.

LEGEND

- 8" SANITARY SEWER
- - - 8" STORM SEWER
- - - 8" WATER
- BURIED CONDUIT
- EXISTING UTILITY
- FUTURE WORK (BY OTHERS)
- ROADWAY CENTERLINE
- EXISTING MANHOLE
- EXISTING CATCH BASIN
- EXISTING INLET
- MANHOLE
- CATCH BASIN
- END SECTION
- VALVE
- FIRE HYDRANT
- ELECTRICAL SERVICE HANDHOLE
- RIPRAP

<p>NOTE: DIMENSIONS MAY BE ADJUSTED TO BE OBTAINED BY SCHEDULING AND PARTITION OF THIS DRAWING.</p> <p>DESIGNED BY: GPK 08/05</p> <p>DRAWN BY: OSH 08/05</p> <p>CHECKED BY: INTLALS</p> <p>DATE:</p>	<p>1. 4/9/05 Layout Changes Per Notes GPK</p> <p>2. 10/04/05 Grids Modification GPK</p> <p>NO. DATE REVISION INTLALS</p>	<p>DATE:</p> <p>DISTRIBUTION:</p>
<p>Clark Dietz</p> <p>DESIGN FIRM REGISTRATION NO. 152-000450</p>		
<p>CHAMPAGNE, ILLINOIS MILWAUKEE, WISCONSIN EVANSVILLE, INDIANA INDIANAPOLIS, INDIANA KENOSHA, WISCONSIN</p>		
<p>VILLAGE OF ST. JOSEPH COMMUNITY PARK</p>		
<p>PAVING AND UTILITY PLAN</p>		
<p>Sheet Number S01066</p>	<p>Drawing Number 3</p>	